



	Materials	Fluids	Maximum Pressure (bar)	Temperature		Characteristics	Page
				Min.	Max.		
Industrial Blowguns							
<p>Polymer</p> 	Technical polymer	Compressed air	10	-20°C	+50°C	OSHA*	428
<p>Blowguns with special features</p> 	Technical polymer, Nickel-plated brass	Compressed air	10	-20°C	+50°C	Safety, SUVA safety, Energy saving, OSHA*	429
<p>Nozzles</p> 	Nickel-plated brass	Compressed air	10	-15°C	+50°C	A large number of nozzles for all your applications	430
<p>Metal</p> 	Aluminium or nickel-plated brass	Industrial fluids	20	-20°C	+100°C	Robustness, lightweight & ergonomic	432
<p>Blowgun Kits</p> 	Technical polymer	Compressed air	10	-20°C	+50°C	Easy to use, ready for use/safety & performance	434

*Certificates available on www.parker.com

Standard Blowguns



4 ranges of blowguns to adapt to basic, standard, safety and energy saving applications. Assembled or in kit form to offer flexibility, in technical or metallic polymers, they can meet all needs.

Technical Characteristics

- **Compatible Fluids:** Compressed air
Other fluids: contact us
- **Working Pressure:** 0 to 10 bar
- **Working Temperature:** Air: -15°C to +50°C
Dry air: -20°C to +80°C
- **Tubes:** Tubes and hoses

Advantages

Basic & standard blowguns:

- In compliance with international noise and pressure regulations
- Swivel nozzles for directional jet
- Progressive flow rate

Safety blowguns:

- Meets OSHA or SUVA standards according to model and complies with:
 - noise exposure requirements
 - provisions relating to outlet pressure
- Energy-saving blowguns:
- Limited flow for lower energy consumption
- Kits and nozzles: to ensure a suitable product

Component Materials

Silicone-free

Body:
technical polymer

Connection:
nickel-plated
brass



Nozzle:
• aluminium
(Standard blowgun)
• nickel-plated brass
(Safety and
other blowguns)

Trigger:
technical polymer

Regulations

- **PED**
- **RoHS**
- **REACH**
- **Protection of design:**
All designs and models of Parker Legris blowguns have been registered with the following numbers:
13 224/13 225/13 226
- **OSHA**
- **DI: 2003/10/CE**
Regulation relating to exposure to noise, particularly with regard to risks to hearing. The noise level must be less than 87 dBA

Operation: Safety Blowgun



Flow stopped completely and pressure reduced to 0.5 bar

Operation: Blowgun with Safety Nozzle



Flow diverted and pressure reduced to 0.5 bar



Maximum Flow Rate
(tolerance +/-10%)



Noise Level
ISO 15744



Diffusion
Cone



Compliance
with Standards

Standard Blowguns

AK13 Blowgun with aluminium extension tube fixed nozzle

Impact resistant plastic



A



Female Thread G1/4 AK13

nozzle, impossible to replace

Progressive flow depending on the trigger position

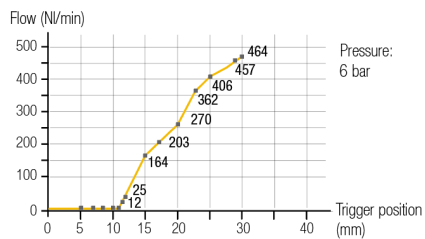

464 Nl/min



OSHA 1910.95 (b)
2003/10/EC directive:

AK13SE AK13-Set in Display Box



A



Female Thread G1/4 AK13SET

10x AK13 in display box

AM13 Blowgun without nozzle, Female BSPP Thread

Impact resistant plastic



C

C1



G1/4 M12x1.25 AM13

AK26SF Blowgun with aluminium extension tube fixed nozzle

Impact resistant plastic



A



Plug Series 26 AK26SF

AJ13 Blowgun with aluminium extension tube, Female BSPP Thread

Red impact resistant plastic



C



Extension tube

G1/4	AJ13/06B	6 mm bent
G1/4	AJ13/08B	8 mm bent
G1/4	AJ13-300	8 x 300 mm straight
G1/4	AJ13-500	8 x 500 mm straight
G1/4	AJ13-1000	8 x 1000 mm straight

Complementary Products

HOSE REEL ENCLOSED CASE

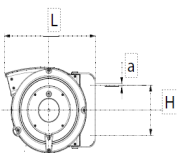

Hose clutch with free return
Hose length upstream: 1,50m
Input connection: bare pipe - Output connection: 1/4" male

Transair®	ØD	Hose Length (m)	Hose i.d. (mm)	Max. Pressure (bar)	H	L	Kg
6698 10 01	6	10	8	15	170	350	3.400
6698 10 02	10.5	16	8	15	251	470	6.440

RECOIL TUBINGS

PA RECOIL TUBINGS PU RECOIL TUBINGS

PA and PU recoil tubings offer an alternative to reels thanks to the remanence of the coil shape given to the tubes

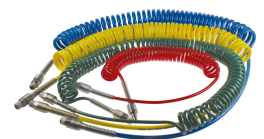

Page 412

Page 408

0654 Safety Blowgun, Lower Connection, Female BSPP Thread

Technical polymer, Nickel-plated brass, NBR

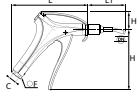

DN	C	F	H	H1	L	L1	Kg	
3	G1/4	0654 00 13	20	117	35	148	73	0.189

Nozzle: nickel-plated brass, NPT version available.

Progressive flow depending on the trigger position

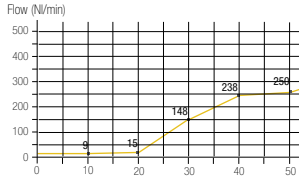

- Pressure: 6 bar
- 250 N/min
- 80 dBA
- OSHA 1910.242 (b)
- OSHA 1910.95 (a)
- 2003/10/EC directive:
- No ear defenders necessary

0654 SUVA Safety Blowgun, Lower Connection, Female BSPP Thread

Technical polymer, nickel-plated brass, NBR

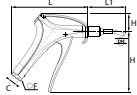

DN	C	F	H	H1	L	L1	Kg	
3	G1/4	0654 01 13	20	117	35	148	73	0.189

Nozzle: nickel-plated brass, NPT version available.

Progressive flow depending on the trigger position

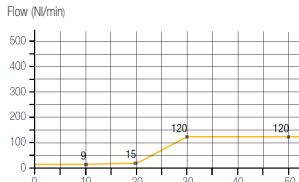

- Pressure: 6 bar
- 120 N/min
- 80 dBA
- OSHA 1910.242 (b)
- OSHA 1910.95 (b)
- 2003/10/EC directive:
- No ear defenders necessary

0653 Energy Saving Blowgun, Lower Connection with Interchangeable Nozzle, Female BSPP Thread

Technical polymer, Nickel-plated brass, NBR

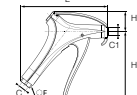

C	C1	F	H	H1	L	L1	Kg
G1/4	M12x1.25	0653 66 13	20	117	34	147	0.144

Flow characteristics depend on the type of nozzle used, delivered without nozzle. An energy saving calculator is available.

Progressive flow depending on the trigger position

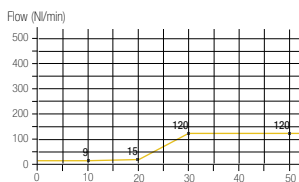

- Pressure: 6 bar
- 120 N/min
- 80 dBA
- OSHA 1910.95 (a)
- 2003/10/EC directive:
- No ear defenders necessary
- Whatever the type of nozzle
- Noise level measured without nozzle
- Depends on type of nozzle

0652 Progressive Control Blowgun, Lower Connection with Interchangeable Nozzle, Female BSPP Thread

Technical polymer, Nickel-plated brass, NBR

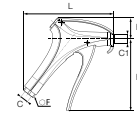

C	C1	F	H	H1	L	L1	Kg
G1/4	M12x1.25	0652 66 13	20	117	34	147	0.163

Flow characteristics depend on the type of nozzle used. Delivered without nozzle.

- Pressure: 6 bar
- 86 dBA
- OSHA 1910.242 (b)
- OSHA 1910.95 (a)
- 2003/10/EC directive:
- Requirement to use ear protection if exposure > 8 hours
- Depending on the type of nozzle
- Noise level measured without nozzle

0651 Progressive Control Blowgun, Lower Connection with Standard Nozzle, Female BSPP Thread

Technical polymer, Nickel-plated brass, NBR

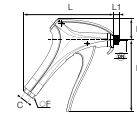

DN	C	F	H	H1	L	L1	Kg	
2.5	G1/4	0651 66 13	20	117	34	147	10	0.168

Nozzle: nickel-plated brass

Progressive flow depending on the trigger position

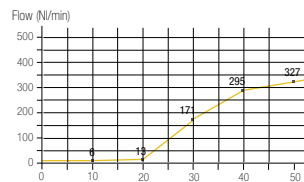

- Pressure: 6 bar
- 327 N/min
- 86 dBA
- OSHA 1910.95 (a)
- 2003/10/EC directive:
- Requirement to use ear protection if exposure > 8 hours
- Flow produced with nozzle 0690 01 00

0656 Progressive Control Blowgun, Lower Connection with Short Angled Nozzle, Female BSPP Thread

Technical polymer, Nickel-plated brass, NBR

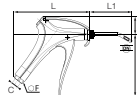

DN	C	F	H	H1	L	L1	Kg	
2.5	G1/4	0656 66 13	20	117	34	147	81	0.173

Nozzle: nickel-plated brass

Progressive flow depending on the trigger position

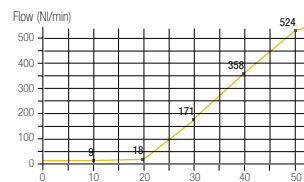

- Pressure: 6 bar
- 524 N/min
- 86 dBA
- OSHA 1910.95 (a)
- 2003/10/EC directive:
- Requirement to use ear protection if exposure > 8 hours
- Flow produced with nozzle 0690 06 01

Nozzles for Polymer Blowguns

0690 01 Standard Nozzle

Nickel-plated brass

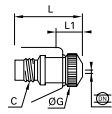

DN	C		G	L	L1	Kg
2.5	M12x1.25		15	31	9	0.023



327 N/min

86 dBA

23°

- Versatile use
- Progressive and powerful air jet

OSHA 1910.95 (b) 2003/10/EC directive: Requirement to use ear protection if exposure > 8 hours

0690 04 Safety Straight Nozzle (Short)

Nickel-plated brass, NBR

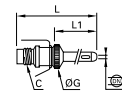

DN	C		G	L	L1	Kg
2.5	M12x1.25		15	102	77	0.034



410 N/min

82 dBA

21°

- Restricted access
- Air screen effect and directional jet
- Safety: avoids the nozzle becoming completely blocked

OSHA 1910.242 (b)/ OSHA 1910.95 (b) 2003/10/EC directive: Requirement to use ear protection if exposure > 8 hours

0690 02 Safety Nozzle

Nickel-plated brass

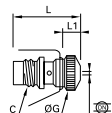

DN	C		G	L	L1	Kg
2.5	M12x1.25		15	31	9	0.024



315 N/min

83 dBA

26°

- Fluidised Powders
- Air screen effect
- Safety: avoids the nozzle becoming completely blocked

OSHA 1910.95 (b)/1910.242 (b) 2003/10/EC directive: Requirement to use ear protection if exposure > 8 hours

0690 05 Angled Nozzle (Long)

Nickel-plated brass, NBR

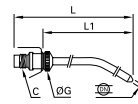

DN	C		G	L	L1	Kg
2.5	M12x1.25		15	316	292	0.065



354 N/min

82 dBA

21°

- Restricted or distant access
- Progressive and powerful air jet
- 360° rotation

OSHA 1910.95 (b) 2003/10/EC directive: Requirement to use ear protection if exposure > 8 hours

0690 03 Straight Nozzle (Long)

Nickel-plated brass, NBR

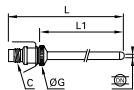

DN	C		G	L	L1	Kg
2.5	M12x1.25		15	332	307	0.067



386 N/min

82 dBA

21°

- Restricted access
- Progressive and powerful air jet

OSHA 1910.95 (b) 2003/10/EC directive: Requirement to use ear protection if exposure > 8 hours

0690 06 Safety Angled Nozzle (Short)

Nickel-plated brass, NBR



DN	C		G	L	L1	Kg
2.5	M12x1.25		15	94	70	0.033



350 N/min

86 dBA

21°

- Restricted access
- Air screen effect and 360° directional jet
- Safety: avoids the nozzle becoming completely blocked

OSHA 1910.242 (b)/ OSHA 1910.95 (b) 2003/10/EC directive: Requirement to use ear protection if exposure > 8 hours

0690 06 01 Angle Nozzle (Short)

Nickel-plated brass, NBR

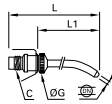

DN	C		G	L	L1	Kg
2.5	M12x1.25	0690 06 01	15	94	70	0.035



- Difficult access
- Progressive and powerful air jet, 360° rotation

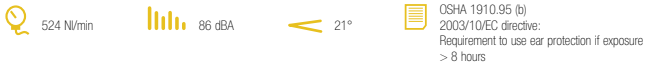

0690 08 COANDA Nozzle

Nickel-plated brass

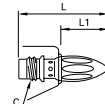

C			L	L1	Kg
M12x1.25	0690 08 00		47.5	26	0.033

Nozzle not compatible with Rectus blowguns



- Directional air jet
- Very quiet, energy-saving
- Safety: avoids the nozzle becoming completely blocked



0690 07 Nozzle with LF 3000® Push-In Connection

Nickel-plated brass, NBR

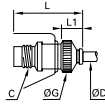

ØD	C		G	L	L1	Kg
4	M12x1.25	0690 07 00	15	35	13	0.024



- Restricted access
- Progressive air jet



0690 10 Safety Booster Nozzle

Nickel-plated brass

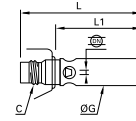

DN	C		G	L	L1	Kg
2.5	M12x1.25	0690 10 00	15	64	42	0.038



- High flow for blowing large surfaces
- Air screen effect
- Safety: avoids the nozzle becoming completely blocked



0690 09 Air Screen Safety Nozzle

Nickel-plated brass

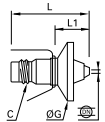

DN	C		G	L	L1	Kg
2	M12x1.25	0690 09 00	30	40.5	18.5	0.021

Deflector: technical polymer



- High flow for blowing large surfaces
- Air screen and deflector to avoid particles being blown back
- Safety: avoids the nozzle becoming completely blocked

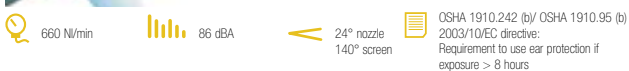

0690 11 Safety Booster Nozzle with Air Screen

Nickel-plated brass

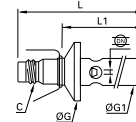

DN	C		G	G1	L	L1	Kg
2.5	M12x1.25	0690 11 00	30	15	76	54	0.045

Deflector: technical polymer



- Same advantage as the Booster nozzle
- Safety: avoids the nozzle becoming completely blocked
- Air screen and deflector avoid particles being blown back

